

PACKING LIST

- 1 - Splash Guard
- 1 - Dust Pan
- 1 - Cap with Screen
- 1 - Cap
- 1 - Adapter (VMC-1006A)

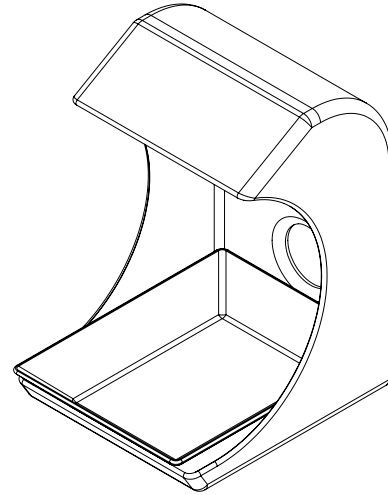

ASSEMBLY INSTRUCTIONS

1. Remove the Unit and other parts from the box and check against the packing list.
2. Attach the dust collector hose to the 2-1/2" port on the back. Use the supplied adapter to attach a 1-1/2" hose to the port.
3. Put cap with screen over dust collector hose or adapter.

RECOMMENDED USAGE

1. The Splash Hood should be positioned appropriately to maximize dust and debris collection.

VANIMAN ADAPTER GUIDE

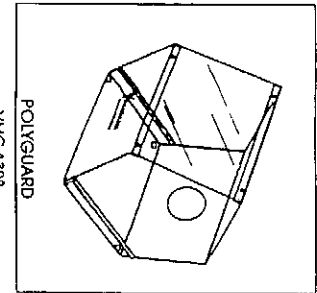
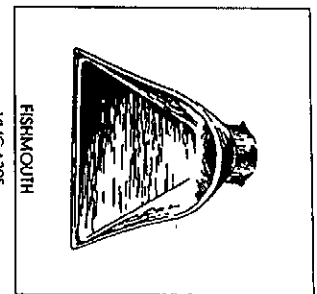
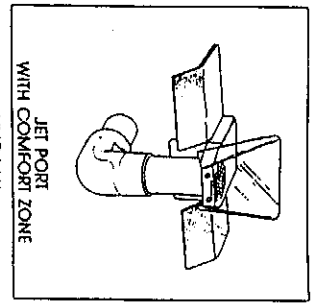
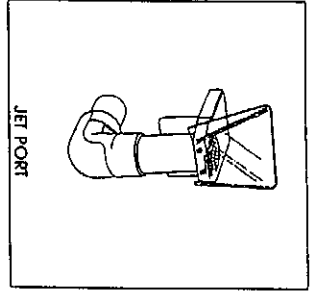
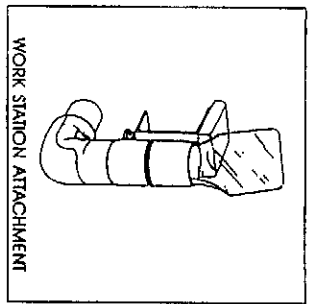
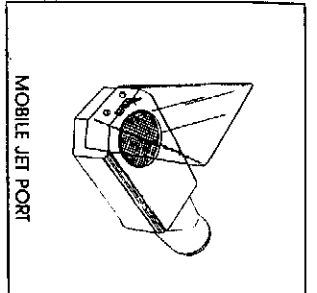

ADAPTERS

NO ADAPTER REQUIRED

ADAPTER REQUIRED:
1 1/2" Pipe to 2 1/2" Hose Female

ADAPTER REQUIRED:
1 1/2" Hose to 2 1/2" Accessory

NO ADAPTER REQUIRED

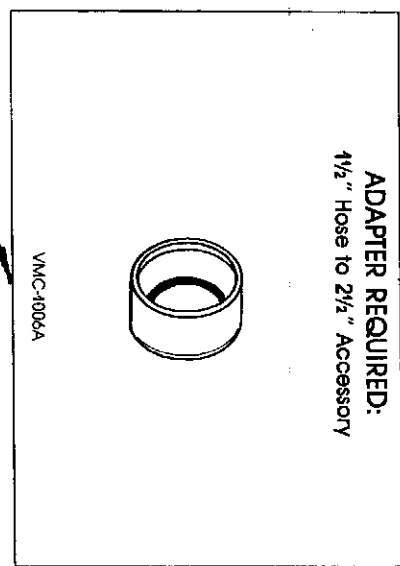
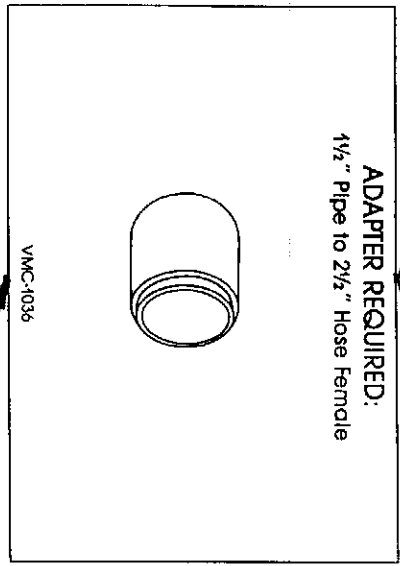

HOSES

To Accumulator
or
Van-I-Vac



HOSE END (VMC-1009)
(1 1/4" Inside Diameter)

To Accumulator
or
Van-I-Vac STAR



HOSE END
(2 1/4" Outside Diameter)

(Comes with all Van-I-Vacs or 2 Station Stars)

Comes with all Van-I-Vac Stars)

For More Information, Call VANIMAN Manufacturing: 1-800-VANIMAN . P.O. Box 74, Fallbrook, CA 92028