

INSTRUCTIONS

1. Remove the tubing from the bottom fitting of the sand tank. See illustration 2 for instructions on quick fittings.
2. Remove the handpiece assembly ⑦ from inside the cabinet by pulling the tubing through the rubber grommet.
3. Unscrew the nozzle cap ⑥ and remove the tip ⑤ and the sealing washer ④. Using a pair of pliers, grasp the handpiece insert ③ and with a twisting motion pull the tubing through the handle ②. Try not to damage the part with pliers. Pull the handpiece insert from the tubing by twisting and pulling.

NOTE: On some units, a steel barbed nozzle may be in the tubing - this should be removed from the tubing and discarded, it can no longer be used with the new long lasting polyurethane tubing. It may be necessary to moisten the tubing and/or soak the tubing in warm water to ease onto the barb at the bottom of the sand tank.

4. Using the new piece of tubing, push the tubing through the handle-using a twisting motion. When the tubing is through the handle, pull in out several inches and press the handpiece insert ③ all the way onto the end of the tubing, until the tubing is flush with the front of the insert (see inset). It may be necessary to moisten the tubing to ease the installation of the handpiece insert.
5. Pull the tubing back into the handle until the collar on the handpiece insert is butted-up to the end of the handle. Pull the tubing through the rubber grommet and re-attach it to the jar assembly by pushing it into the quick-release fitting. Re-assemble the sealing washer, tip and nozzle cap to the handle.
6. Blow out tank bottom fitting and press tubing back into the tank. Visually make sure the tube travels past the black seal looking through the transparent raised area.

Figure 1
⑦

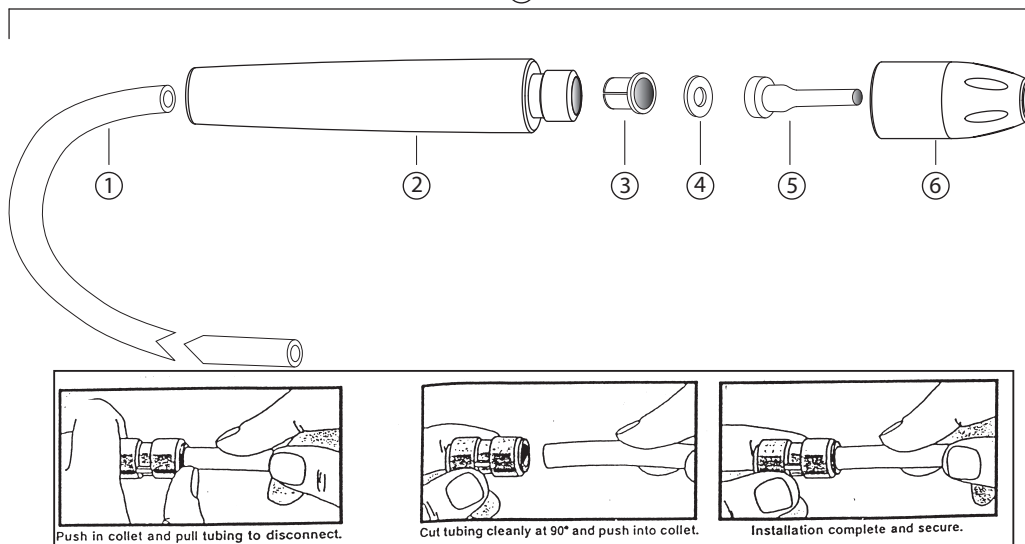

HANDPIECE PARTS

Number	Description	Re-Order Number	Corresponding unit
1	Anti-Static Handpiece Tubing	97928 (2ft.) 97929 (3ft.) 97930 (4ft.) 2192 (by the foot)	SandStorm Edge, Professional, 2, Expert, & Problast 2 SandStorm XL & Problast SandStorm Prestige & Problast 3 -
2	Handle	2191	All Units
3	Handpiece Insert	2187	All Units
4	O-Ring	97909 (5-pack)	All Units
5	Tip (o-ring included)	See Below	All Units
6	Nozzle Cap	2177	All Units
7	2ft. Handpiece Assembly* 3ft. Handpiece Assembly* 4ft. Handpiece Assembly* 6ft. Handpiece Assembly*	97947 97949 97959 98109	SandStorm Edge, Professional, 2, Expert, & Problast 2 SandStorm XL & Problast SandStorm Prestige & Problast 3 SandStorm Mobile & Mobile Problast

*Does not include o-ring or tip

BLASTER TIPS

Tip Type	Part No.	Color	Nozzle Size	Recommended Vaniman Media	Recommended Tank Assembly	
					Part Number	Description
Crystal Tip (2 per pack)	97902	Blue	Medium 0.032" (0.8mm)	25µm Al2O3	97956	25µm
	97903	Black	Large 0.048" (1.2mm)	50µm Al2O3	97957	50-100µm
				50µm Glass Bead		
				100µm Al2O3		
	97904	Red	Extra Large 0.065" (1.6mm)	50µm Glass Bead	97958	110-250µm
				100µm Al2O3		
Tungsten Carbide Tip (1 per pack)	97905	Yellow	Small 0.026" (0.65mm)	25µm Al2O3	97956	25µm
	97906	Green	Medium 0.036" (0.91mm)	50µm Al2O3	97957	50-100µm
				50µm Glass Bead		
				100µm Al2O3		
	97907	Violet	Large 0.059" (1.5mm)	50µm Glass Bead	97958	110-250µm
				100µm Al2O3		
250µm Al2O3						

BLASTER MEDIA

Material	Size	Order Number		Applications
		Box, 15lbs.	One Tank	
Aluminum Oxide	25µm	97921	97935	Fine surfacing of metal and other hard materials.
	50µm	97922	97936	Deburring and deflashing of metals and other hard materials.
	100µm	97923	97937	Aggressive removal of materials, semi-rough finished surface.
	250µm	97924	97938	Bulk removal or surface cleaning of tough materials. Rough surface preparation.
Glass Bead	50µm	97925	97939	Smoothing/polishing. Cleans and polishes without removing material.
Sodium Bicarbonate	50-100µm	97934	98200	Aggressive removal of materials, water soluble and does not embed into the material.
Walnut Shell	250µm	97931 (50lbs.)	-	Organic, used for cleaning purposes.
	100µm	97932	-	
	50µm	97933	-	