

THE 1 1/2 " ACCUMULATOR

- 1 - Accumulator
- 1 - Mounting Bracket
- 1 - Circular Clamp
- 2 - #8 Screws
- 1 - Elbow Adaptor

INSTALLATION AND MOUNTING :

The Accumulator comes with a mounting bracket that may be fastened to a wall by using the two #8 wood screws provided or other wall fasteners to attach the bracket in place before assembling the Accumulator. To fasten to a wall, loosen the large band clamp and remove from the Accumulator. Fasten to the wall or other vertical surface before sliding the Accumulator back into the clamp and tightening. Leave enough room (1-2 inches) under the cup so that it may be emptied.

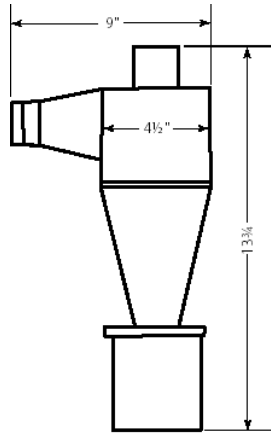

Small Accumulator (VMC-A100)
Hose connections: Outside 1 3/4" hose

HOSE CONNECTION:

The Accumulator is installed between the workstation and the vacuum system. Connect the hose from the dust collector to the outlet on top of the Accumulator. The hose collecting the debris should connect to the inlet tube, horizontal arm, of the Accumulator.

Standard 1 1/2" plastic PVC water pipe sizes were used on the inlet and outlet so that standard fittings, available at the hardware or plumbing store, can be easily obtained. A 1 1/2" elbow is supplied for the outlet if the Accumulator is to be mounted under the bench. The PVC fittings are slip-fit on the Accumulator and may be easily removed by pulling and twisting at the same time. Your existing vacuum hoses may be adapted using PVC pipe fittings and reducers. Adapters and hoses are available from your supplier or call Vaniman direct (1-800-VANIMAN or 1-760-723-1498 in California).

OPERATION:

Make sure the collection cup is snapped into place on the bottom of the unit. The metal toggle latches hold the cup in place. To remove the cup, make sure the vacuum system is off. Gently tap the sides of the Accumulator to shake down dust into the cup. Hold the collection cup with one hand on each side directly below the toggle latches. With your index fingers, flip the toggles upward then swing the wire bales outward. Lower the cup and empty the contents. Replace the cup onto the bottom rim of the Accumulator, swing the wire bales over the bottom rim of the Accumulator, and snap the toggle latches down to secure the cup in place.

Turn the vacuum system on and use as you normally would. As the collector pot fills with dust, you can see the material through the translucent walls of the pot. It is best to empty the pot daily or when it is half full.