

## Warnings and Precautions

This Fume Extractor is designed to run on 115 volt alternating current, 60 Hz supply voltage in temperatures ranging from -10 to +40 degrees celcius. With a maximum current usage of 15 amps. The plug on the unit labeled "Power" is for the supply line cord provided. The supply plug in the wall must have a wired ground and if the back cover is removed for any reason, do not bypass the protective earthing.

This dust collector is to be used for capturing fine aerosols or fumes, and is not suitable for direct liquid suction.

When placing the unit in a location be sure that the power connector is accessible at all times. Any side of the dust collector that has a vent on it must be a minimum of 2 inches from any obstruction, and have a vent area of 20 square inches to allow ventilation to ambient room air. This will keep the unit cool and ensure a longer motor life.

Failure to comply with the precautions listed here or any others for this equipment may cause electrical shock or equipment failure.



- Alternating Current



- Caution, risk of electrical shock

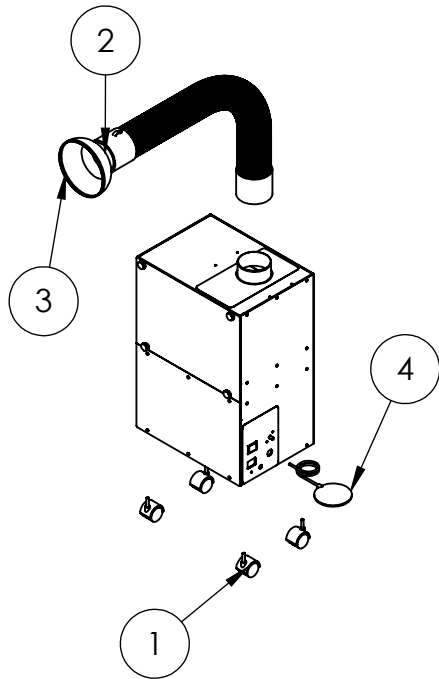

Replacement Parts		
Fig. #	Description	Part Number
1	Caster Wheels	3140
2	Extra Rigid Capture Hose	96101
3	Nozzle (5 Pack)	96102
4	Foot Remote/Bellows	1443

**IMPORTANT SERVICE INFORMATION:**  
SAVE SHIPPING BOX AND FOAM FOR FUTURE SERVICE. SHIPPING WITHOUT PROPER FOAM MAY CAUSE DAMAGE TO UNIT

**PACKING LIST**

- |                                   |                         |
|-----------------------------------|-------------------------|
| 1 - Pure Breeze FX Fume Extractor | 1 - Power Cord          |
| 1 - Extra Rigid Capture Hose      | 4 - Caster Wheels       |
| 1 - Nozzle                        | 1 - Foot Remote/Bellows |

**ASSEMBLY INSTRUCTIONS**

- Once the unit is removed from its packaging, remove the four caster wheels from the bag packed with the power cord. Lay the unit on its back on top of several pieces of foam packaging to protect it. Screw the four caster wheels into the four threaded holes in the bottom of the unit. Use the supplied Spanner Wrench to tighten the caster wheel to the case, BUT DO NOT OVER TIGHTEN.
- Remove the four thumb screws on the front of the unit, as well as the filter cover panel to expose the HEPA and Charcoal Odor Filter inside the unit. Remove both filters from the unit, and then remove the plastic packaging from both of the filters. Return the filters back into the unit in the correct order with the Charcoal Odor Filter sitting on top of the HEPA Filter. Replace cover panel and thumb screws.
- Connect the Extra Rigid Capture Hose to the top of the unit by sliding the black hose adapter onto the inlet tube (only one end of the hose will fit). Slide nozzle into opposite end of the hose and lock it by twisting the nozzle clockwise until you feel a click. Adjust the hose to the desired position. If your hose loses rigidity and is struggling to stay in the desired position, add rigidity by holding the hose firmly with one hand and twisting the hose in the counter clockwise direction (with regards to looking down the hose). Keep twisting until the hose reaches the desired rigidity. If the hose is twisted in the wrong direction, the hose will begin to bulge in that area and become even less rigid. If continued the hose will break.
- Plug one end of the removable power cord into the socket labeled "Power Cord" on the side of the unit, and the other end into a standard grounded wall socket. Test the unit by flipping the *On/Off* switch into the *On* position. **NOTE:** If using the *On/Off* switch to turn the unit *On*, you MUST use the same switch to turn the unit *Off*.

5. While the unit is *Off*, plug the black foot remote tube into the round black port labeled "Remote" on the unit. To use the foot remote instead of the *On/Off* switch for sanitary purposes, leave the *On/Off* switch on the side of the unit in the *Off* position. Test the remote function by pressing on the round bellows to turn it *On*; press it again to turn it *Off*. **NOTE:** If using the foot remote to turn the unit *On*, you MUST use the foot remote to turn the unit *Off* as well. Once the foot remote air switch has been activated by the foot remote, the *On/Off* switch will not turn the unit *Off*, only the foot switch will.

---

## **FILTER REPLACEMENT INSTRUCTIONS**

---

It is recommended that you replace the HEPA Filter when it becomes excessively dirty, or every 6-12 months. Replace the Charcoal Odor Filter when its effectiveness has noticeably decreased.

1. Turn off the unit.
2. Remove the four thumb screws on the front of unit and set aside for later use.
3. Remove the panel to expose the HEPA and Charcoal Filter
4. Slide the Charcoal Filter out first, then the HEPA filter by pulling on the tab. Once removed, properly dispose of the dirty filters.
5. Remove any packaging from the replacement HEPA and Charcoal Filter. Carefully align the HEPA filter frame with the outer walls of the unit, sit the filter onto the guide ledge, and slide until the filter stops. Once the HEPA filter is installed, carefully place the replacement Charcoal Filter on top of the HEPA filter.
6. Put the front panel back on the unit and secure with thumb screws.

---

## **MAINTENANCE**

---

1. **Circuit Breaker** - The unit is protected by a circuit breaker on the left side of the unit. In the unlikely event there is an overload condition the breaker may trip. If this happens reset the breaker by pushing on the white button until it clicks into place.
2. **Motor Brushes** - This long life motor does not have replaceable brushes. Replacement motors can be ordered as P/N 97041.

---

## **RECOMMENDED USE**

---

The Pure Breeze FX Fume Extractor is designed for use in collecting toxic or odorous fumes and should not be used for collection of large particulates or wet substances. For an exhaustive list of chemicals compounds that are best filtered with this unit, please visit the Pure Breeze FX Fume Extractor page at [Vaniman.com](http://Vaniman.com).

### REPLACEMENT PARTS

The following items are offered to enhance the usage of your quality Vaniman unit. These items can be order through your supplier using the following part numbers. Please feel free to contact Vaniman Mfg. Co. with questions regarding our products.

<b>Fig. #</b>	<b>Description</b>	<b>Part Number</b>
1	Replacement Motor	97041
2	Motor Gasket	3396
3	Front Cover Thumb Screws, Pair	2984
4	Remote Plug Air Switch	1442
5	Power Switch ON/OFF	2904
6	Power Connector	3010
7	Rotary Switch Knob	1471
8	Rotary Switch	3019
9	Transformer	1419
10	Circuit Breaker, 15Amp	2869
11	Charcoal Odor Filter	97095
12	HEPA Filter	96097
Not Shown	Power Cord	1422

