

## **BOTTOM HOSE FITTING REPLACEMENT (PN 97915)**

### **PACKING LIST**

- 1 - Quick Release Fitting
- 1 - Manifold tube fitting
- 1 - Handpiece tubing (2 ft.)
- 1 - Handpiece insert

### **INSTRUCTIONS**

1. Disconnect the tubing from the top and bottom fittings of the sand tank. See illustration 1 for instructions on quick fittings.
2. Remove the sand tank from the unit by sliding it up and out of its location.
3. Remove the screws on the top of the sand tank cover. Remove the sand tank cover and retaining ring.
4. Unscrew the manifold tube from the tube fitting in the bottom of the sand tank.
5. Using a socket wrench with extension, pliers, or other wrench, hold the brass manifold tube fitting and unscrew the quick release fitting from the bottom of the sand tank.
6. Push the top half of the fitting out of the bottom of the sand tank and discard entire bottom fitting.
7. Insert the new manifold tube fitting into the bottom of the sand tank and install the new quick release fitting using the reverse of step 5 above.
8. Re-install the sand tank on the unit. If you have a braided nylon hose on the handpiece, it is necessary to replace it with the long-lasting urethane tubing included in the kit at no charge. See the attached instructions.
9. Re-connect the proper tubing to the top and bottom fittings of the sand tank.

Illustration 1

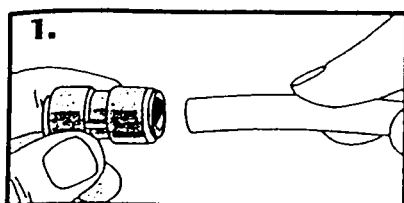

1. Cut tubing cleanly at 90° and push into collet.

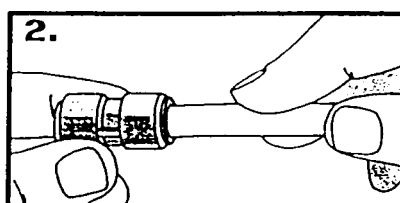

2. Installation complete and secure.

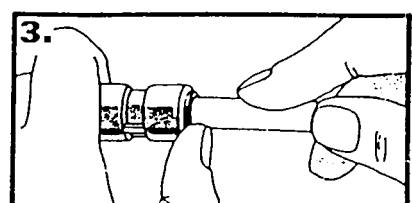

3. Push in collet and pull tubing to disconnect.